

- All dimensions are approximate and may change without notice. If dimensions are required for a specific purpose these can be provided on request.
- Insulation 25mm foam encapsulated within a GRP outer skin. U-value 0.8 W/m2.
- Holing of tank and fitting of connections are done by others unless ordered.
- Tank sides may have a small draw angle for moulding purposes.

Created by	Date	Checked by	Date	Issued	A4	SCALE
TP	11/01/2018		11/01/2018	11/01/2018		NTS
NOTE: All Dimensions are in mm				ANP 50/1 (Flange) Standard		
External Dimensions:				Revision	Sheet	
812 x 634 x 639					1 / 3	

Joiner

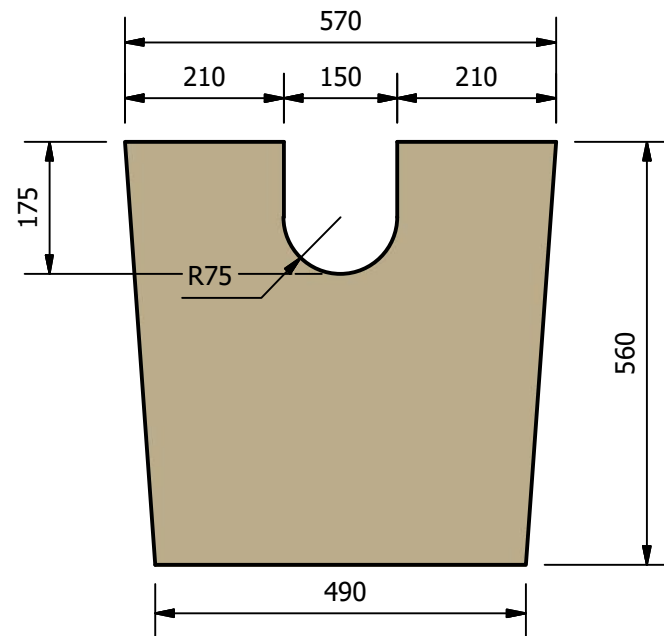
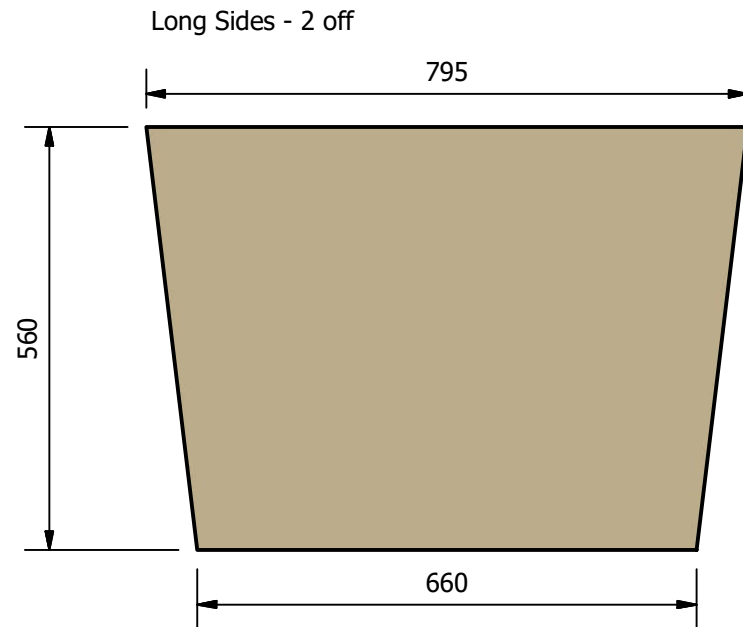

Overflow & Outlet Side - 1 off

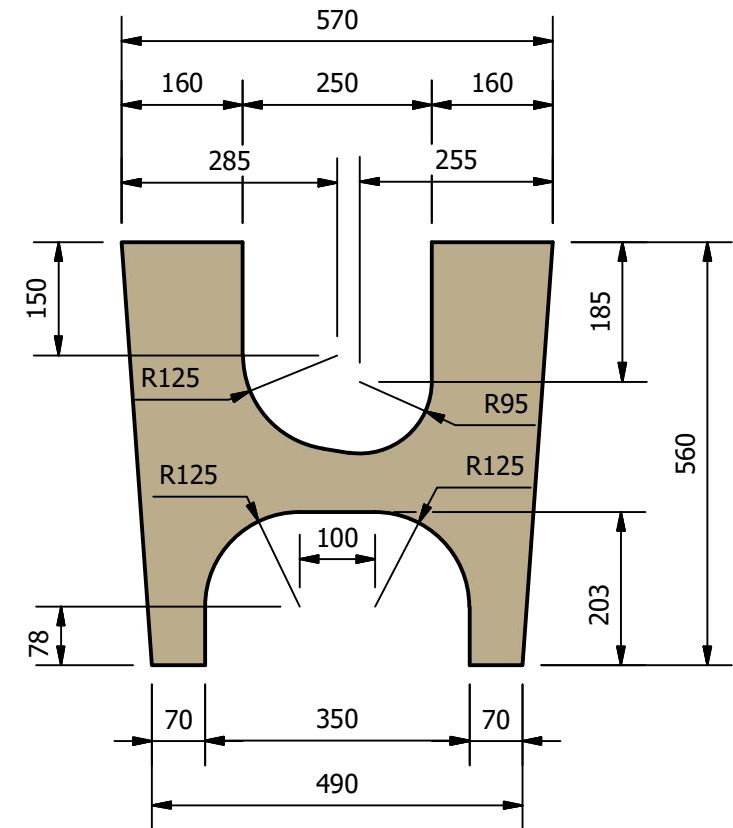

Created by	Date	Checked by	Date	Issued	A4	SCALE
TP	11/01/2018		11/01/2018	11/01/2018		NTS
NOTE: All Dimensions are in mm				ANP 50/1 (Flange) Standard		
External Dimensions: 812 x 634 x 639					Revision	Sheet 2 / 3

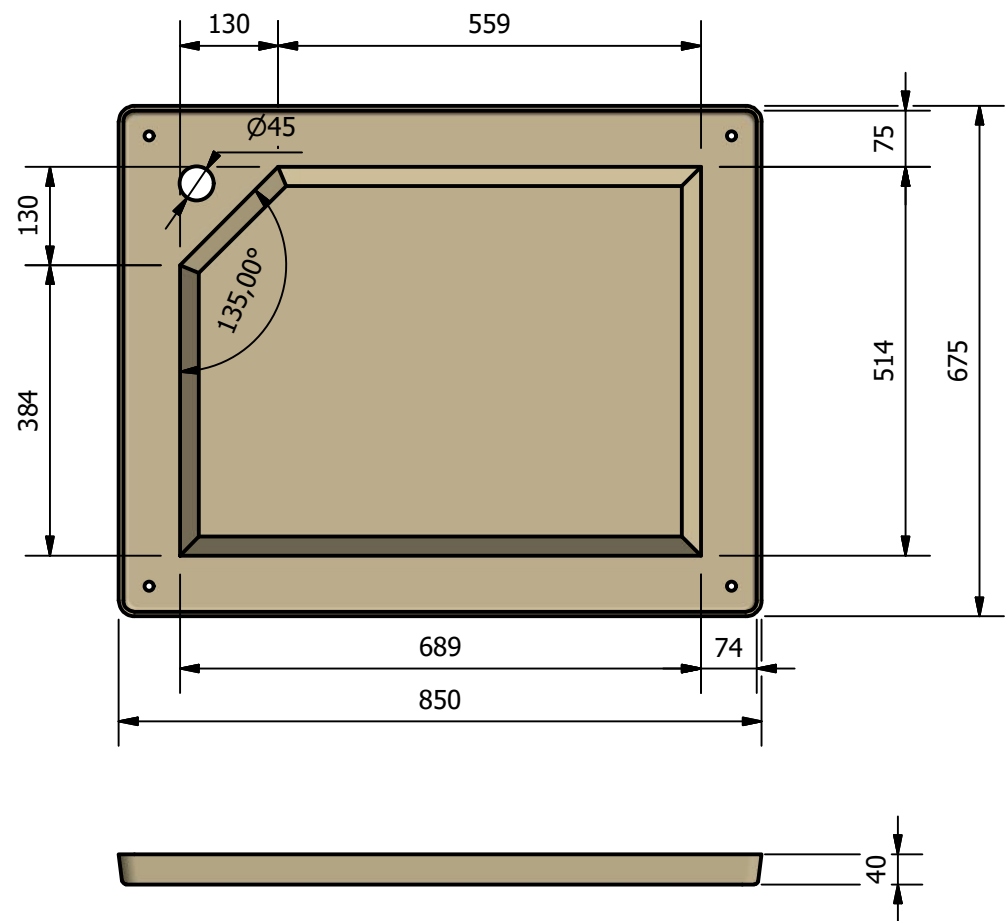

Created by	Date	Checked by	Date	Issued	A4	SCALE
TP	11/01/2018		11/01/2018	11/01/2018		NTS
NOTE: All Dimensions are in mm				ANP 50/1 (Flange) Standard		
				External Dimensions:	Revision	Sheet
				812 x 634 x 639		3 / 3